

# SLIDEART LIFT AND SLIDE DOORS



## The new system of accessories for large lift and slide doors

Easy to use and fluid movements  
High resistance to corrosion  
Certified up to 300kg; up to 400kg with additional kit  
Perfect sealing  
No architectonic restrictions





## New Slideart LS system for lift and slide doors

### More light, more air, more security

Lifting and sliding doors that open out onto gardens and terraces improve the quality of life; they offer more light, more freedom of movement.

### Increased durability and sturdiness

Slideart LS is extremely sturdy because its main components are in stainless steel. It is tested at 300kg and for 25,000 cycles with the possibility of achieving 400kg thanks to the additional roller kit.

### High corrosion resistance

The Slideart LS components have been tested for up to **1000 hours** in salt spray.

### No architectonic restrictions

With SLIDEART LS stepping outside is made easy by the reduced threshold, perfect for the disabled and in compliance with DIN 18025. Beauty is always within reach, without any obstacles or architectonic restrictions.

### Highly fluid movement

The leaves can be operated with ease and comfort thanks to the perfect design and realisation of the sliding components and the sturdy handle with a modern and elegant design.

# Lifting and sliding door certification

SLIDEART LS has been tested at the Giordano institute according to the requirements in EN 13126-16:2008 and EN 13126-1:2012, passing all of the tests required for a 300kg door and guaranteeing a high use cycle (25,000).

The various obtainable levels:  
(in bold levels obtained by SLIDEART LS)

**- 5 300 0 1 4/5 - 16 1200/2000**

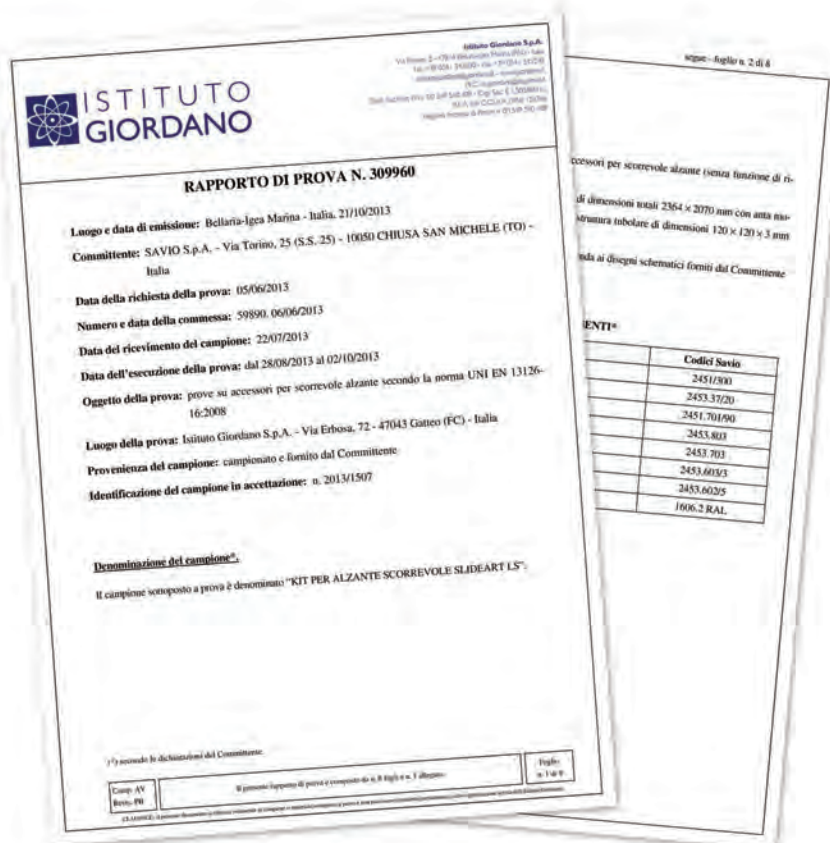
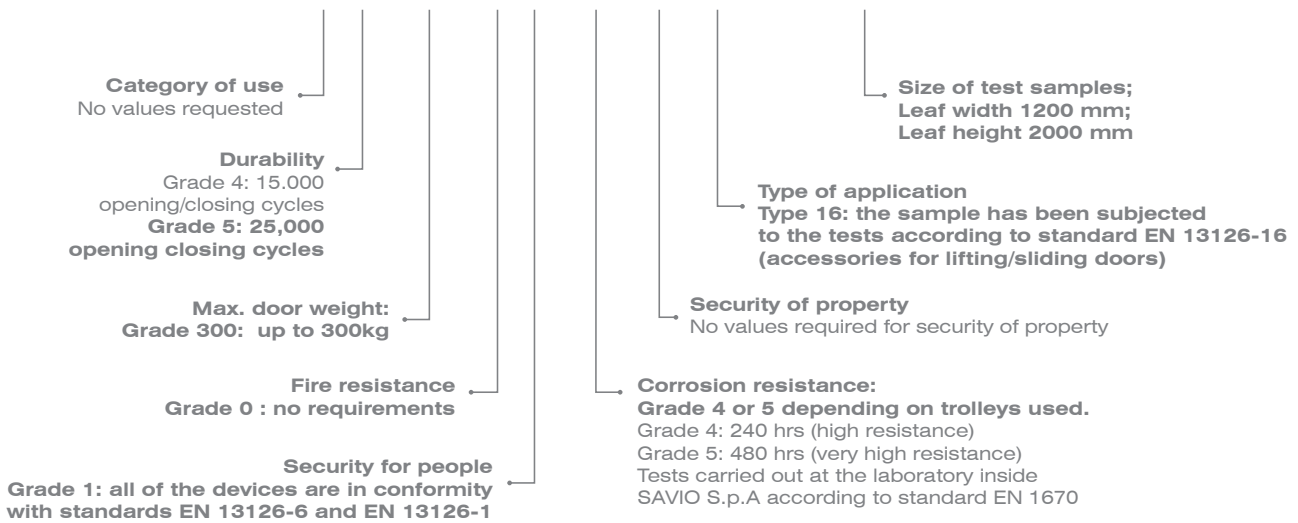

**Field of application:**

<b>Leaf width</b>	Depending on profile system, max. 3000 mm; max. 3400 mm with addition of code 2451/400
<b>Leaf height</b>	Depending on profile system, max. 3100 mm + extension of 625 mm, reaching 3725 mm
<b>Width of external frame</b>	With scheme A, max. 6700 mm
<b>Height of external frame</b>	Depending on profile system
<b>Weight of leaf</b>	Max. 300 kg certified; max. 400 kg with addition of the code 2451/400
<b>Cremone door</b>	37.5 mm
<b>Height of door handle</b>	From the surface of the leaf on which the rollers are rested 953 mm

Adaptation kits for the main series of profiles are available.



ARTICLE	DRAW REF.	DESCRIPTION	PCS/ PACKS
<b>ROLLERS</b>			
2451/300	7-8	300 kg roller kit with chromed steel ball bearings and wheels in nylon.	1
2451.10/300	7-8	300 kg roller kit with stainless steel ball bearings and wheels in nylon.	1
2451/400	7-8	400 kg roller kit with chromed steel ball bearings and wheels in nylon.	1
2451.10/400	7-8	400 kg roller kit with stainless steel ball bearings and wheels in nylon.	1
<b>LOCKS</b>			
2453.37/20	6	Lifting door lock prepared for cylinder. For doors with a height from 1801 mm to 2325 mm.	1
2453.37/23	6	Lifting door lock prepared for cylinder. For doors with a height from 2326 mm to 2700 mm.	1
2453.37/30	6	Lifting door lock prepared for cylinder. For doors with a height from 2701 mm to 3100 mm.	1
2453.137/20	6	Lifting door lock NOT prepared for cylinder. For doors with a height from 1801 mm to 2325 mm.	1
2453.137/23	6	Lifting door lock NOT prepared for cylinder. For doors with a height from 2326 mm to 2700 mm.	1
2453.137/30	6	Lifting door lock NOT prepared for cylinder. For doors with a height from 2701 mm to 3100 mm.	1
<b>BARS</b>			
2451.701/90	9	895 mm roller connection bar. For doors with a width from 700 mm to 1600 mm.	1
2451.701/150	9	1500 mm roller connection bar. For doors with a width from 1601 mm to 2200 mm.	1
2451.701/220	9	2200 mm roller connection bar. For doors with a width from 2201 mm to 3000 mm.	1
<b>LOCKING PIECE KIT</b>			
2453.701	10	Kit of 2 16 mm locking pieces.	10
2453.702	10	Kit of 2 17 mm locking pieces.	10
2453.703	10	Kit of 2 24 mm locking pieces.	10
2453.704	10	Kit of 2 22 mm locking pieces.	10
2453.705	10	Kit of 2 15 mm locking pieces.	10
2453.706	10	Kit of 2 15 mm locking pieces for micro ventilation.	10
2453.707	10	Kit of 2 14.5 mm locking pieces.	10
2453.709	10	Kit of 2 11 mm locking pieces.	10
2453.710	10	Kit of 2 13.5 mm locking pieces.	10
2453.711	10	Kit of 2 24.5 mm locking pieces.	10
<b>ACCESSORIES</b>			
1606.2	1 ÷ 5	Interior handle and external roller tray. Finishing: F, HL, 9500, 9010.	1
2451.705		Rod guide kit.	1
2453.799/1		Kit of 2 spacers for locking catches 37x13x1 mm.	10
2453.810		Extension from 625 mm for locks.	1
2453.815		Leaf stop.	1
<b>SMALL PARTS KIT AND ADAPTERS</b>			
2453.800	11 ÷ 17	Small parts kit and adapters from 14.5 mm.	1
2453.801	11 ÷ 17	Small parts kit and adapters from 15.8 mm.	1
2453.802	11 ÷ 17	Small parts kit and adapters from 18.8 mm.	1
2453.803	11 ÷ 17	Small parts kit and adapters from 20.5 mm.	1
2453.804	11 ÷ 17	Small parts kit and adapters from 23 mm.	1
2453.805	11 ÷ 17	Small parts kit and adapters from 25 mm.	1
2453.806	11 ÷ 17	Small parts kit and adapters from 30 mm.	1
2453.807	11 ÷ 17	Small parts kit and adapters from 17 mm.	1
2453.850	11 ÷ 17	Adapter kit from 14.5 mm.	1
2453.851	11 ÷ 17	Adapter kit from 15.8 mm.	1
2453.852	11 ÷ 17	Adapter kit from 18.8 mm.	1
2453.853	11 ÷ 17	Adapter kit from 20.5 mm.	1
2453.854	11 ÷ 17	Adapter kit from 23 mm.	1
2453.855	11 ÷ 17	Adapter kit from 25 mm.	1
2453.856	11 ÷ 17	Adapter kit from 30 mm.	1
2453.857	11 ÷ 17	Adapter kit from 17 mm.	1

Summary of components

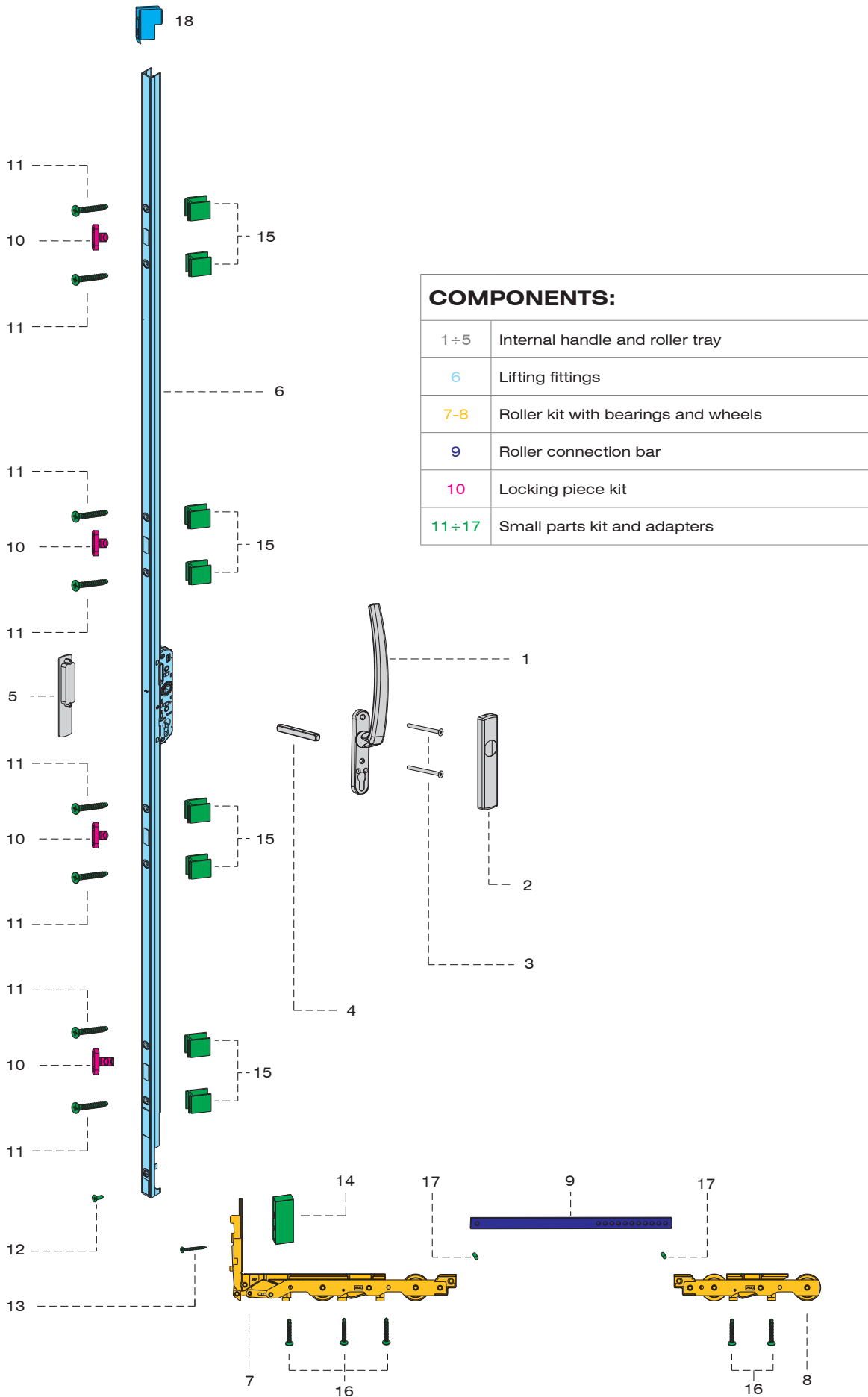

Sizes and fitting information depending on profile

Sections A-B

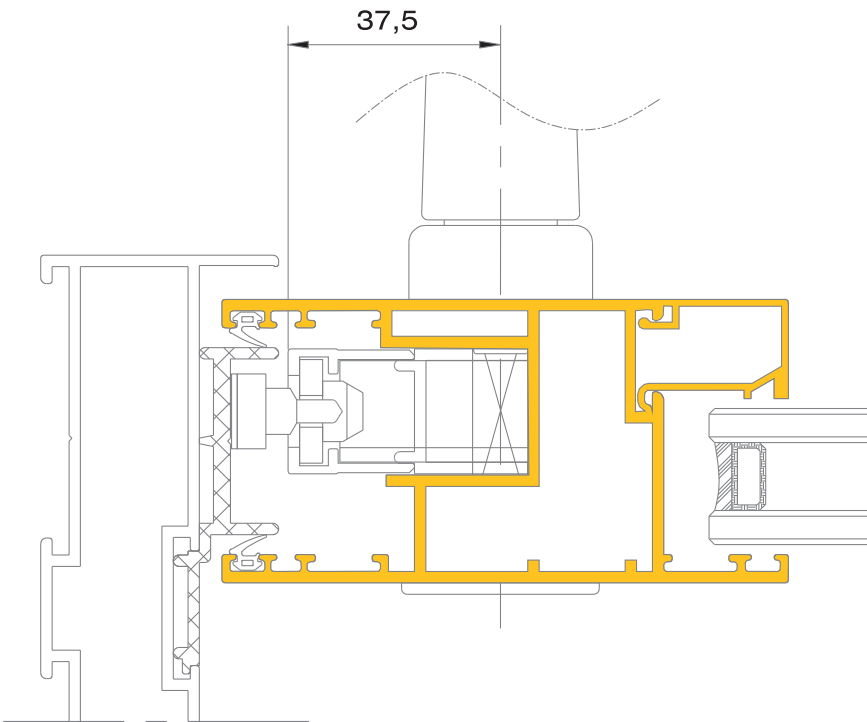

Sections C-D

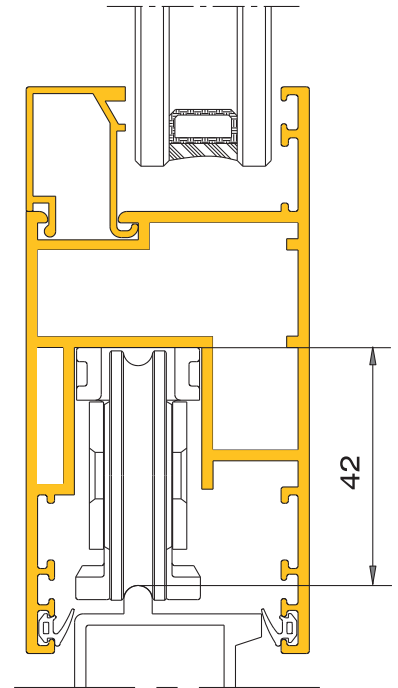

Handles with internal closure

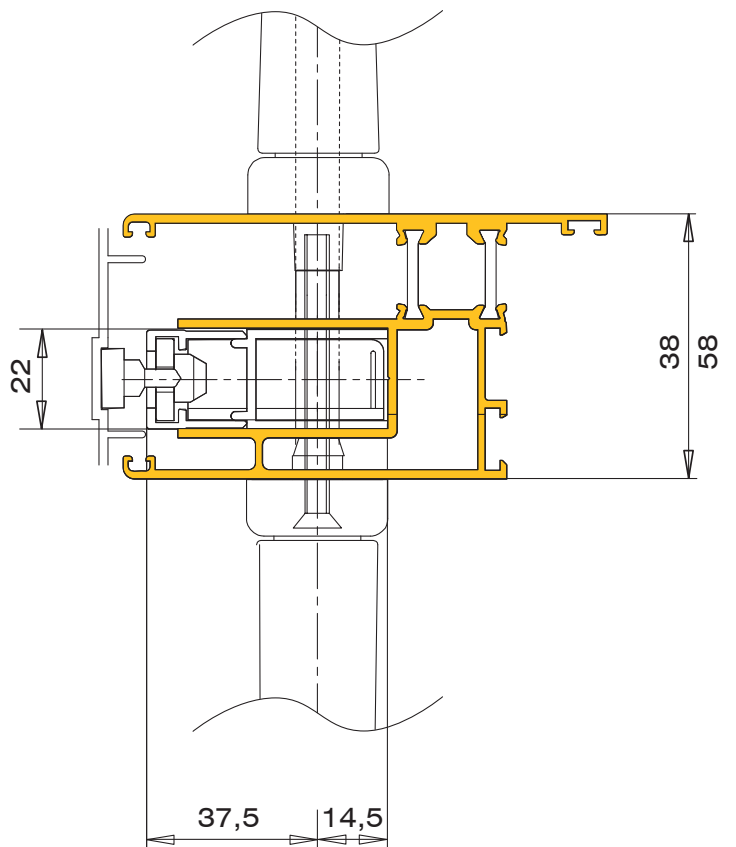
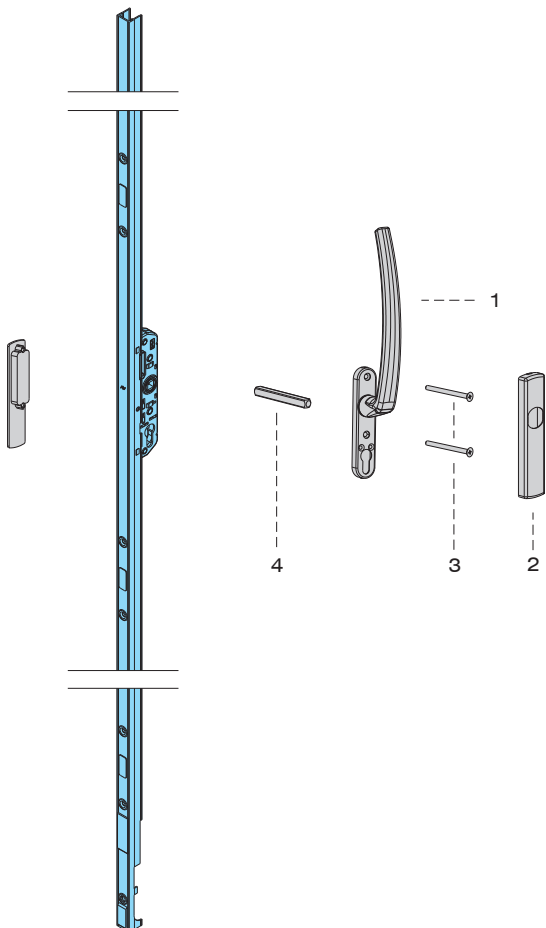



Achievable combinations

— Fixed leaf

— Opening leaf

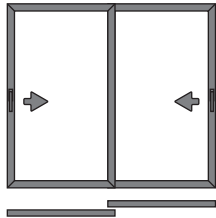

SCHEME A

N°. of opening leaves	2
Max. sash width (mm)	6.800

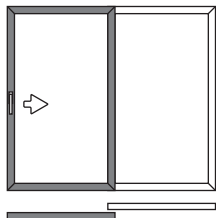

SCHEME B

N°. of opening leaves	1
Max. sash width (mm)	3.400

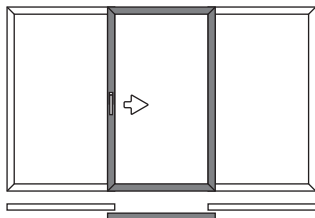

SCHEME C

N°. of opening leaves	1
Max. sash width (mm)	3.400

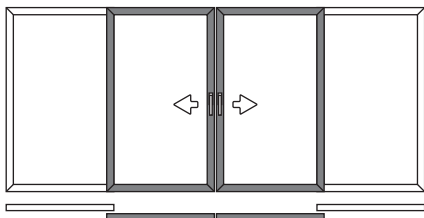

SCHEME D

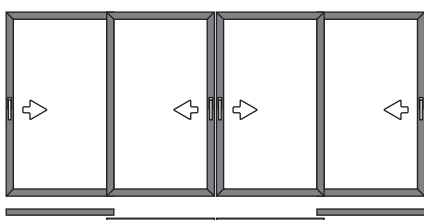

N°. of opening leaves	2
Max. sash width (mm)	6.800

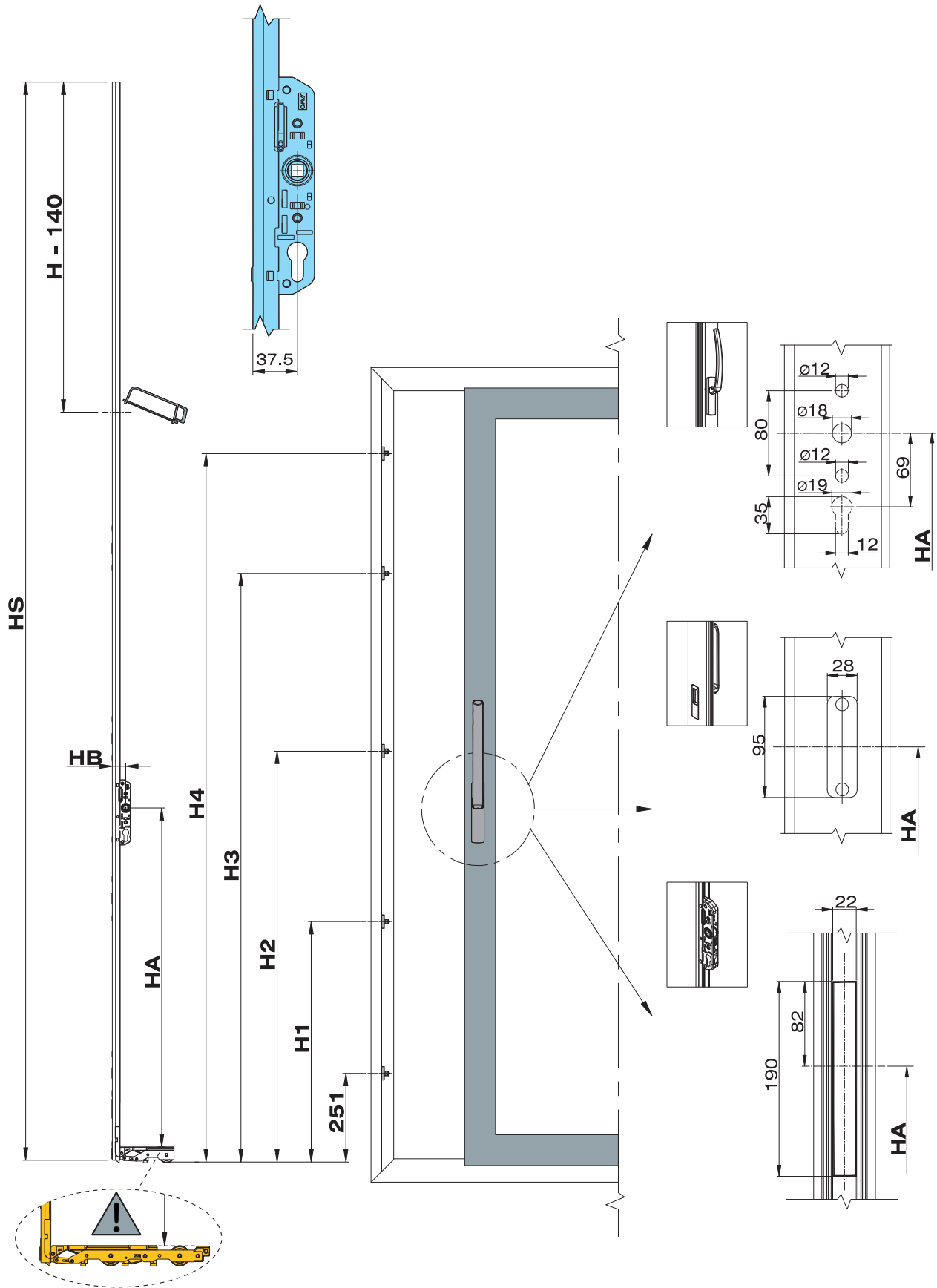

SCHEME E

N°. of opening leaves	4
Max. sash width (mm)	13.600



H (leaf height mm)	Entrance (HB) 37.5 mm								
	Article	HS	HA	H1	H2	H3	H4		
1801~2325	2453.37/20 - 2453.137/20	2185	953	608	1209	1601	-	8	4
2326~2700	2453.37/23 - 2453.137/23	2375	953	608	1209	1906	-	8	4
2701~3100	2453.37/30 - 2453.137/30	3000	953	608	1209	1906	2423	10	5





Savio S.p.A.  
Via Torino, 25 (S.S. 25) - 10050 Chiusa S. Michele (TO)  
Tel. +39 011 964 34 64 - Fax +39 011 964 34 74  
[www.savio.it](http://www.savio.it) - [export@savio.it](mailto:export@savio.it)

